

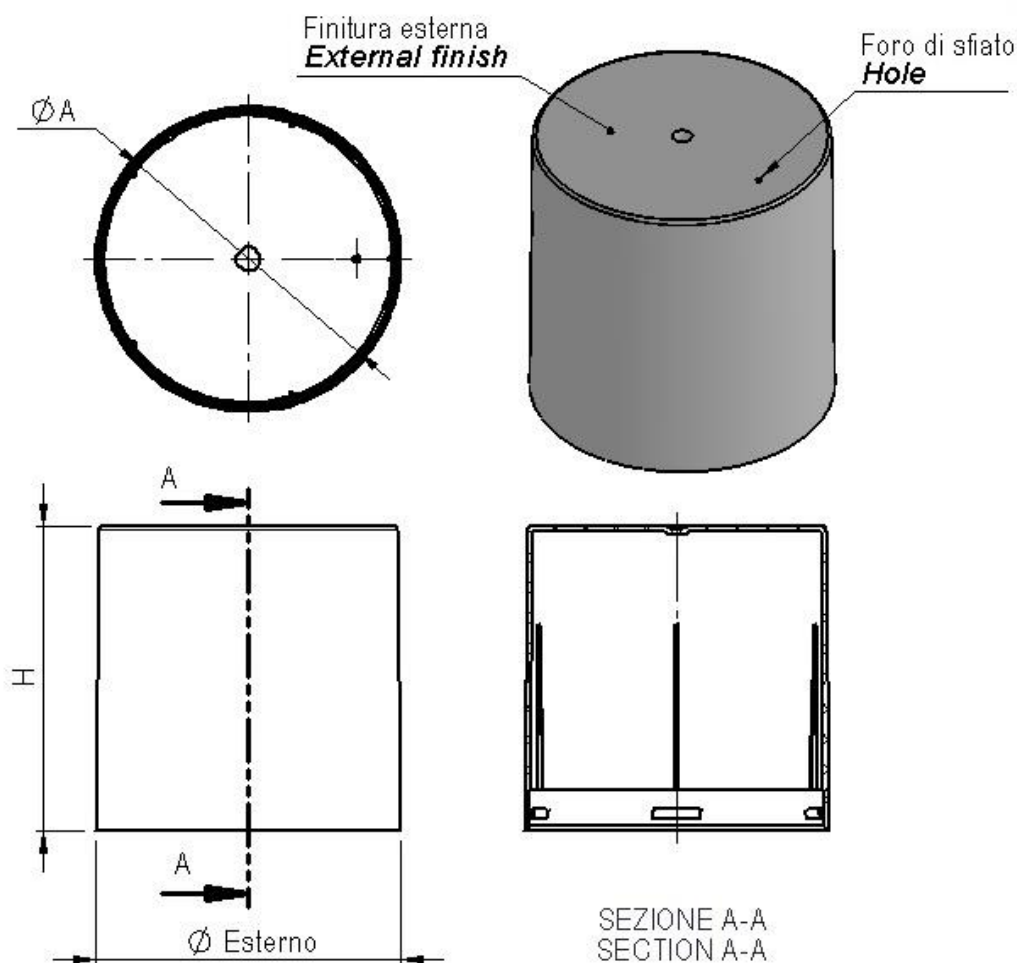





**Art. cod. CPN00146**  
**Descrizione / Description**  
**Cappuccio Necked-in**  
**Necked-in cap**

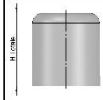
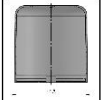

**Tabella dati tecnici / Technical data table**

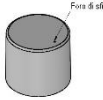
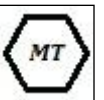
						
Ø Esterno (mm) External Ø (mm)	Altezza H (mm) Height H (mm)	Ø Aggancio A (mm) Ø Engagement A (mm)	Finitura esterna External finish	Foro Hole	Materiale Material	Peso (g) Weight (g)
45,15	45	42,65	Lucido/Glossy	Si/Yes	PP 5	5,70 ±0,20

Il peso indicato è puramente indicativo e non valido ai fini CONAI.  
 The weight indicated is purely indicative.

## Tabella dati imballaggio-spedizione / Table packing and shipping details

Scatola standard (cm)	Sacchetto	Quantità per scatola	Quantità per pallet	Pallet (cm)
Standard box (cm)	Bag	Pcs box	Pcs pallet	Pallet (cm)
79x39 H:52	PE Food contact	1056	6336	120x80 H:115,5

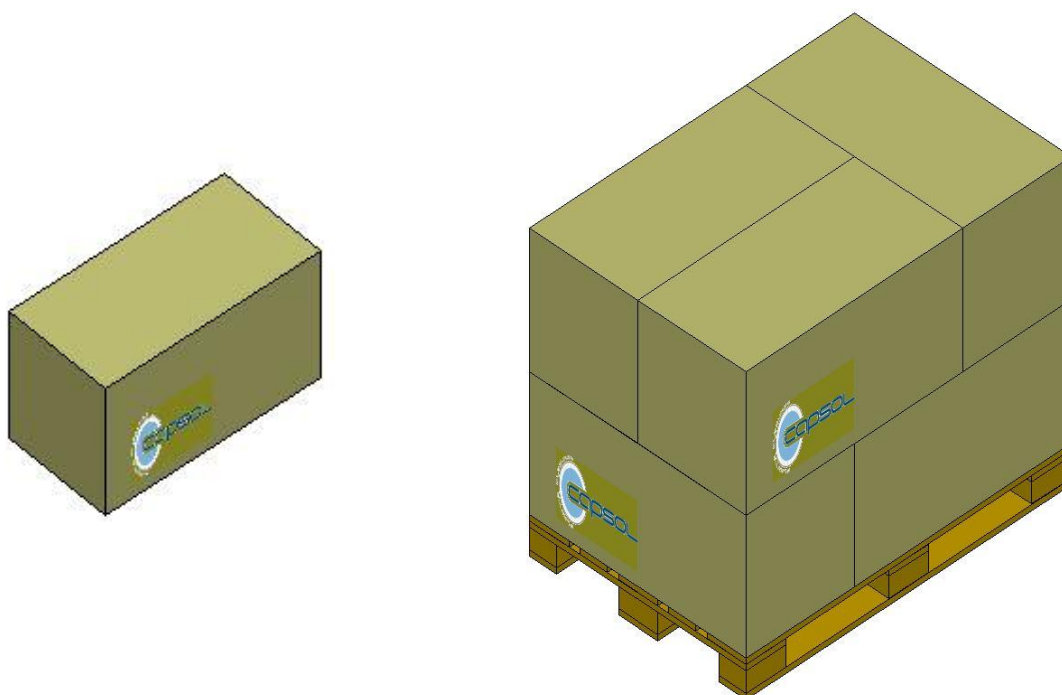

## Stoccaggio / Storage

Conservare i prodotti nella loro confezione originale in un luogo pulito, fresco e asciutto.  
*Store the products in their original packaging in a clean, cool and dry place.*

Temperatura / Temperature : **5÷30°C**

Umidità / Humidity : **45÷75%**

Conservare i prodotti a temperatura ambiente (**20°C±5**) per **48 ore** prima dell'uso sulla macchina confezionatrice.  
*Store the products at room temperature (20°C±5) for 48H before using on packaging machine.*