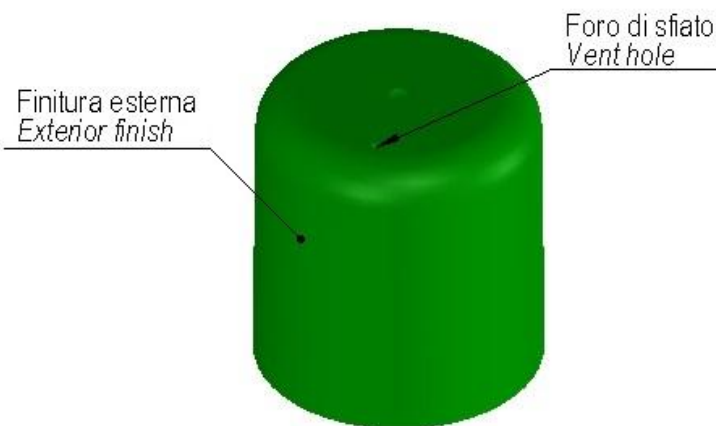
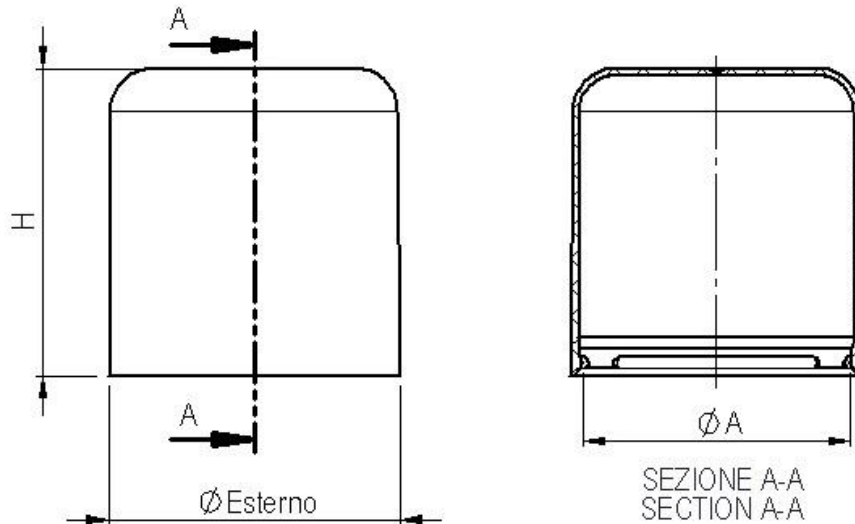
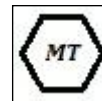
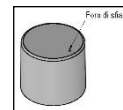
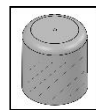
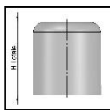

**Art. cod. CPG00533**
**Descrizione / Description**
**Cappuccio a gorge  $\varnothing 45 \times 47$  con foro**  
**Gorge cap  $\varnothing 45 \times 47$  with vent hole**

**Tabella dati tecnici / Technical data table**

$\varnothing$ Esterno (mm) External $\varnothing$ (mm)	Altezza H (mm) Height H (mm)	$\varnothing$ Aggancio A (mm) $\varnothing$ Engagement A (mm)	Finitura esterna External finish	Foro Hole	Materiale Material	Peso (g) Weight (g)
44,6	47,0	41,0	Lucida/Glossy	Si/Yes	PP 5	6,80 $\pm$ 0,25

Il peso indicato è puramente indicativo e non valido ai fini CONAI.  
 The weight indicated is purely indicative.

## Tabella dati imballaggio-spedizione / Table packing and shipping details

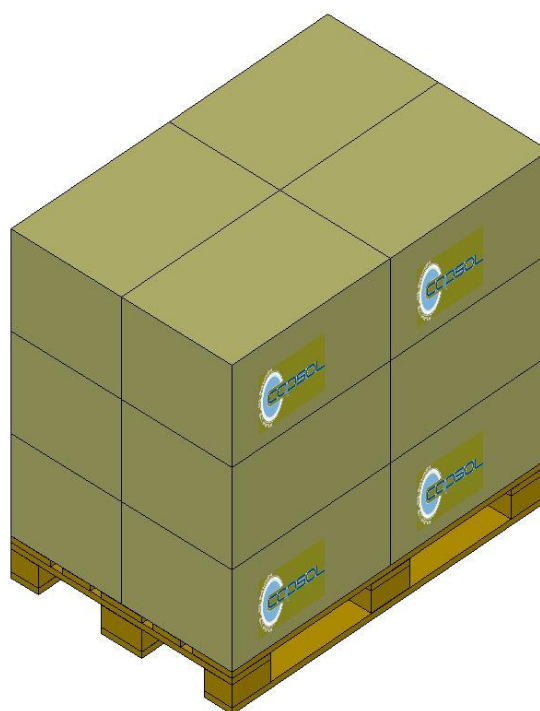
Scatola standard (cm)	Sacchetto	Quantità per scatola	Quantità per pallet	Pallet (cm)
Standard box (cm)	Bag	Pcs box	Pcs pallet	Pallet (cm)
60x40 H:33,5	PE Food contact	600	7200	120x80 H:112



## Stoccaggio / Storage

Conservare i prodotti nella loro confezione originale in un luogo pulito, fresco e asciutto.  
*Store the products in their original packaging in a clean, cool and dry place.*

Temperatura / Temperature : **5÷30°C**

Umidità / Umidity : **45÷75%**

Conservare i prodotti a temperatura ambiente (**20°C±5**) per **48 ore** prima dell'uso sulla macchina confezionatrice.  
*Store the products at room temperature (20°C±5) for 48H before using on packaging machine.*